

Note: Make sure to insert nuts and set screws into pieces before assembly.

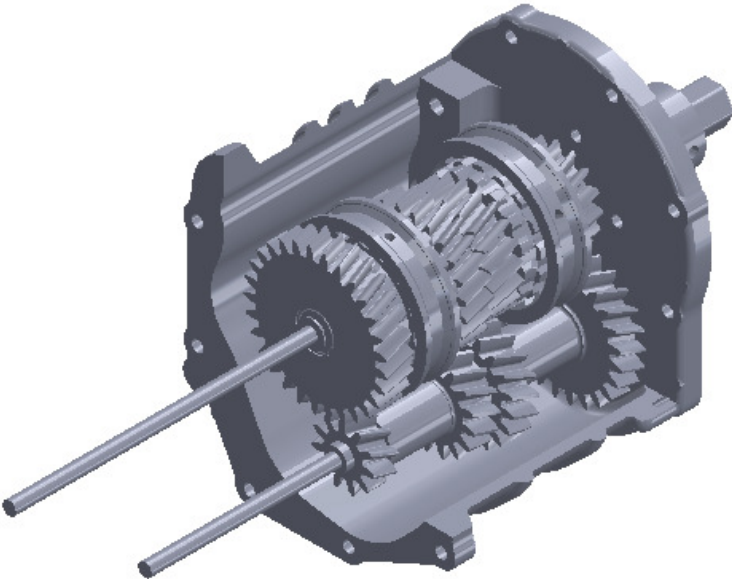

SCALE 1 : 4

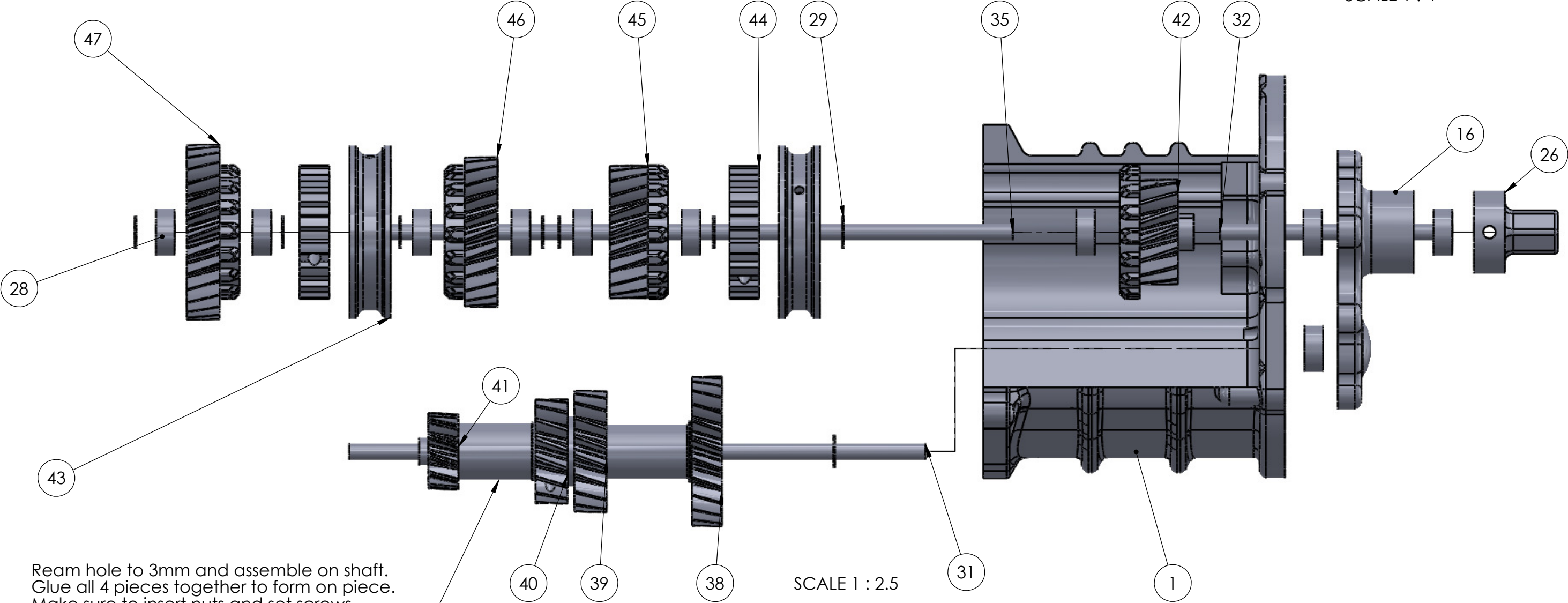

SCALE 1 : 2.5

Ream hole to 3mm and assemble on shaft.
Glue all 4 pieces together to form on piece.
Make sure to insert nuts and set screws
before glueing.

ITEM NO.	PART NUMBER	QTY.
1	Transmission housing 1	1
2	Transmission housing 2	1
3	Transmission housing 3	1
4	3-4 shift collar fork	1
5	1-2 shift collar fork	1
6	1-2 shift fork	1
7	5-R shift fork	1
8	3-4 shift fork2	1
9	Gear 5 Counter shaft	1
10	Gear 5 Top	1
11	Shift collar gear - 5th	1
12	5th gear Shift collar	1
13	Reverse Gear	1
14	Reverse idler	1
15	Transmission housing 2 bearing retainer	1
16	Front bearing retainer	1
17	Bell housing	1
18	Output shaft	1
19	Shift linkage	1
20	Shifter base	1
21	Shifter base 1	1
22	Shifter base 2	1
23	Shifter ball top	1
24	Shifter ball bottom	1
25	Transmission housing 3 - Shell - cover	1
26	input shaft	1
27	Transmission housing 1 Cover	1
28	623zz bearing	18
29	3mm washer	20
30	1-2 and 3-4 shift rail	2
31	Counter Shaft	1
32	Input Shaft-	1
33	Reverse idler - 5th gear shift rail	2
34	Shifter	1
35	Top Shaft	1
36	Shift Linkage 2	1
37	Shift Linkage 3	1
38	Gear 1 Counter shaft	1
39	Gear 2 Counter shaft	1
40	Gear 3 Counter shaft	1
41	Gear 4 Counter shaft	1
42	Gear 1 Top	1
43	Shift collar	2
44	Shift collar gear	2
45	Gear 2 Top	1
46	Gear 3 Top	1
47	Gear 4 Top	1